

Field of education:
Mechanical engineering

Professional qualification:
CNC operator

Exercise:
**Programming of CNC machine
(solution)**

Variant:
Task 28 – Support plate 4.3.

Solution:

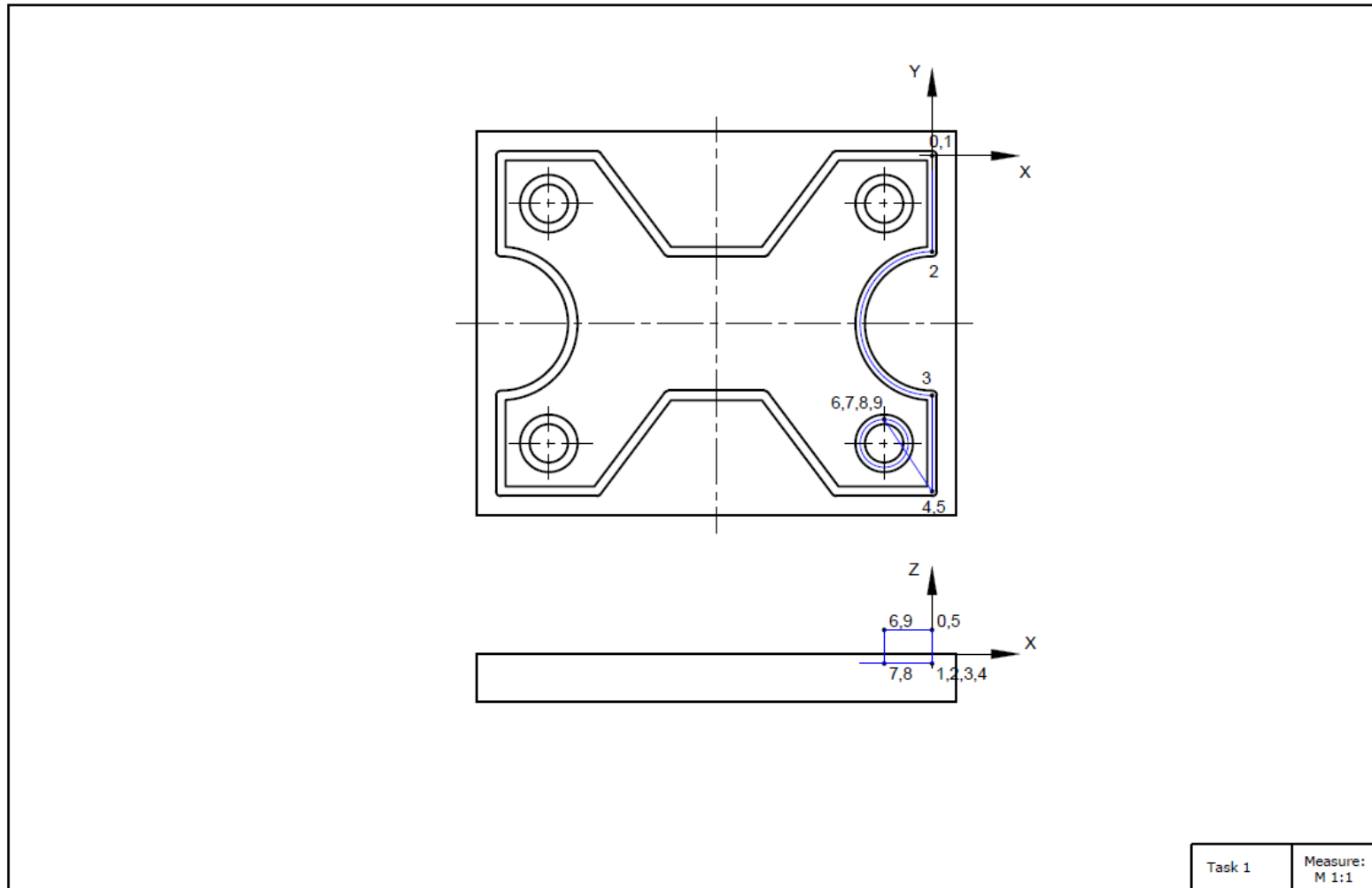

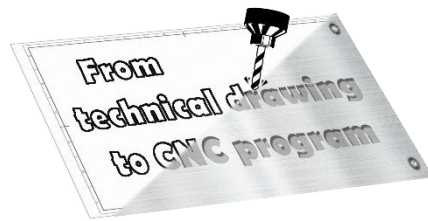

Required written code that should be inserted into the control unit:

G1 Z-2

Y-20

G2 Y-50 R15

G1 Y-70

Z5

G0 X-10 Y-55

G1 Z-2

G2 X-10 Y-55 I0 Y-5

G1 Z5

M30

Explanation of the G-code:

%Setting the coordinate system $x=0$, $y=0$, $z=5$; point 0

G1 Z-2 %Tool entry into material; point 1

Y-20 %Straight milling; point 2

G2 Y-50 R15 %Radial milling; point 3

G1 Y-70 %Straight milling; point 4

Z5 %Lifting of tool; point 5

G0 X-10 Y-55 %Positioning; point 6

G1 Z-2 %Tool entry into material; point 7

G2 X-10 Y-55 I0 Y-5 %Circle milling; point 8

G1 Z5 %Lifting of tool; point 9

M30 %End of program